

Opening to route Ac lines to terrace at below beam level and covering the AC lines

CUT OUT IN SLAB FOR ROUTING AC DUCTS

Existing Stores building

Record room 7550 x 4335

| Sl.no | NOTES |
|-------|--|
| 1. | DO NOT SCALE THE DRAWING. READ THE DIMENSION ONLY. |
| 2. | ALL DIMENSION ARE IN MM. |
| 3. | ANY DISCREPANCY SHALL BE BROUGHT TO THE NOTICE OF THE ARCHITECT IMMEDIATELY. |

| Sl. no | LEGEND | SYMBOL |
|--------|--|--------|
| 1. | SINGLE GANG CONTROL SWITCH | |
| 2. | SINGLE TUBE LED LIGHT | |
| 3. | CEILING FAN | |
| 4. | TWIN LED TUBE LIGHT | |
| 5. | FALSE CEILING LED TUBE LIGHT | |
| 6. | ACCESS CARD READER | |
| 7. | WEATHER PROOF SOCKET | |
| 8. | SINGLE TWO WAY SWITCH NEAR STAIRS | |
| 9. | CEILING MOUNTED EXTERNAL FITTING | |
| 10. | CCTV | |
| 11. | INTERNAL DB | |
| 12. | ELECTRICAL PANEL | |
| 13. | CEILING MOUNTED LED FITTING IN COMMON SPACES | |
| 14. | MIRROR SLEEK LED TUBE LIGHT | |
| 15. | EXTERNAL WALL MOUNTED BULK HEAD | |
| 16. | EXHAUST FAN IN WASH ROOM | |
| 17. | CEILING DROP | |
| 18. | GRID FALSE CEILING- 600X600MM | |
| 19. | SMOKE DETECTOR | |
| 20. | MCP % HOOTER SET | |
| 21. | PULL BOX | |
| 22. | FALSE CEILING SQUARE FITTING 600MM X 600MM | |
| 21. | FALSE CEILING SQUARE FITTING 150X150MM | |
| 22. | CASSETTE AC UNIT | |
| 23. | HI WALL SPLIT AC UNIT | |

NOTE : Grid false ceiling height in the cabins +3200mm from FFL
Grid False ceiling height in the Workstations area, Meeting room & Front desk + 2900mm from FFL.
No Grid false ceiling in Record Room.

| REV. NO | DESCRIPTION | DATE |
|---------|--|----------|
| R1 | Grid false ceiling in Record room is removed | 02.06.23 |

NATIONAL CENTRE FOR BIOLOGICAL SCIENCES, TIFR GKVK CAMPUS, BELLARY ROAD, BLORE-56.

PROJECT: PROPOSED EXPANSION OF CENTRAL STORES @ NCBS CAMPUS, GKVK, BANGALORE.

TITLE: GRID FALSE CEILING PLAN FOR SECOND FLOOR

ARCHITECT: Santhak.S

DATE: 29.05.23

SCALE: 1:100

DRG No: NCBS/ECS/AR-WP-52

R1

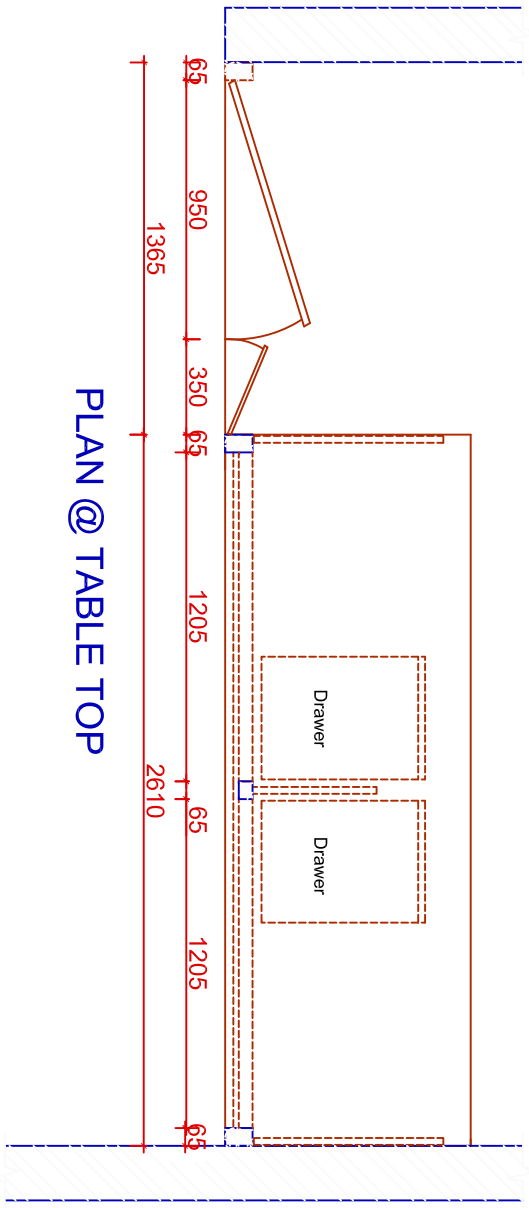

PLAN @ TABLE TOP

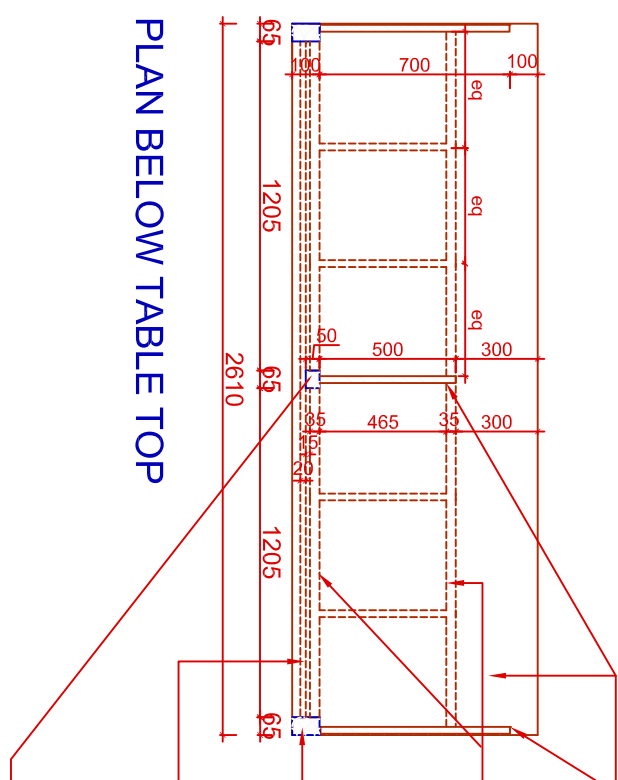

PLAN BELOW TABLE TOP

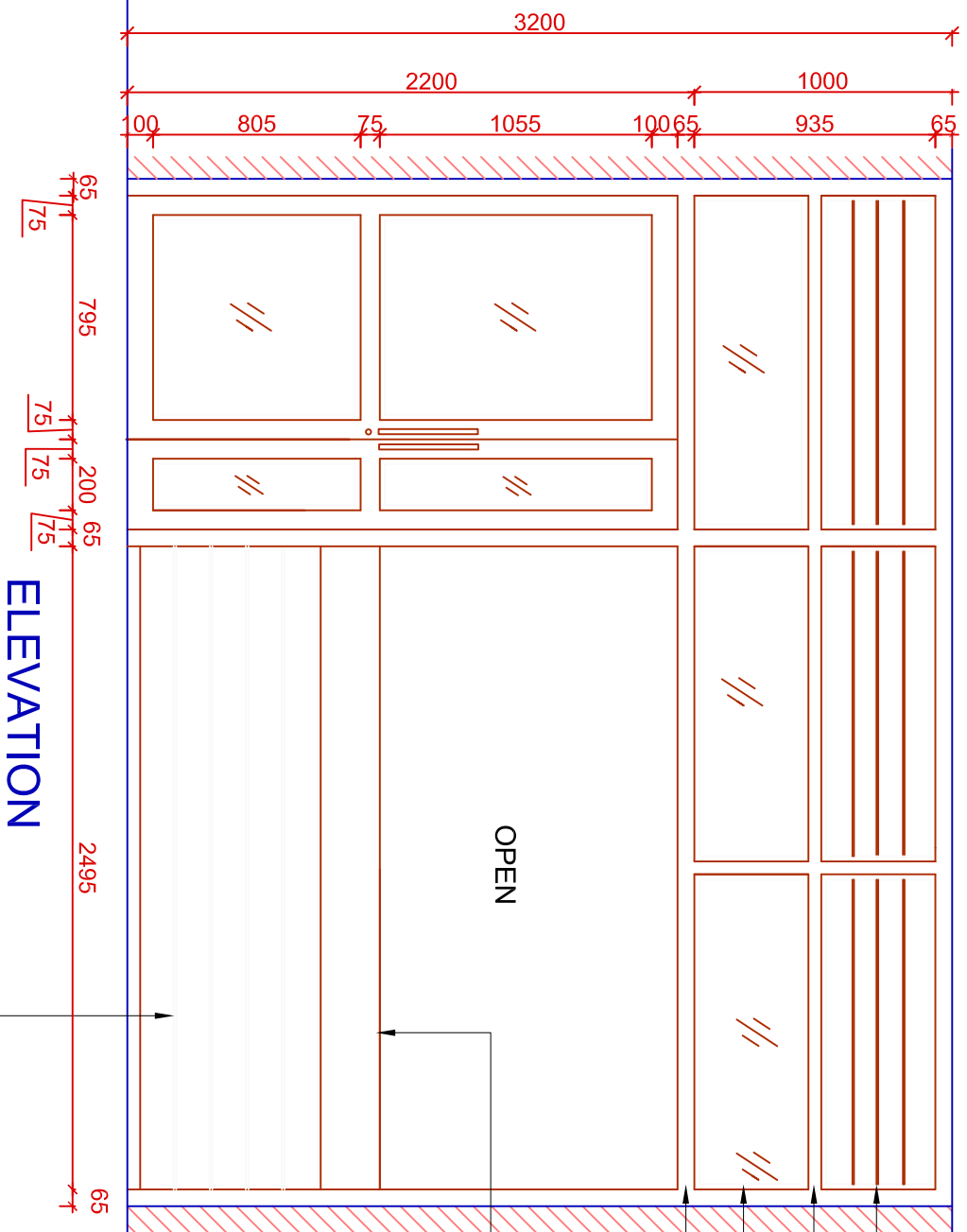

ELEVATION

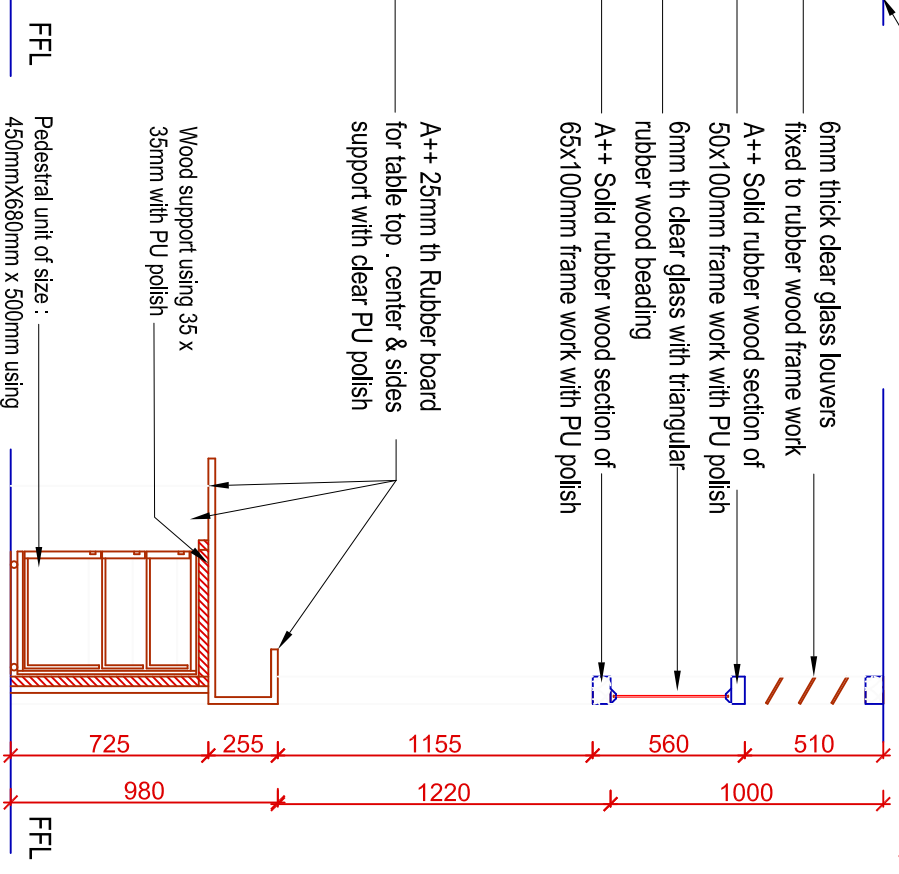

SECTION AT A'-A'

Bottom of slab
6mm thick clear glass louvers fixed to rubber wood frame work
A++ Solid rubber wood section of 50x100mm frame work with PU polish
6mm th clear glass with triangular rubber wood beading
A++ Solid rubber wood section of 65x100mm frame work with PU polish

Wood support using 35 x 35mm with PU polish
Pedestal unit of size : 450mmX680mm x 500mm using 18mmth & 12mm th lumper board with concealed handles, single lock, lockable castors & drawer slides.
25mm Thick modesty panel using rubber wood with PU polish sunken groove of 5x5mm @ 150 c/c

A++ 25mm th Rubber board for table top . center & sides support with clear PU polish
Rubber wood support using 35x35mm with Pu polish along the horizontal length of the table on both sides with tie frame
A++ Solid rubber wood section of 65x100mm supporting frame work with clear PU polish
18mm th A++ Rubber board with Sunken groove of 10x10mm at equal distance with PU polish for Modesty panel
A++ Solid rubber wood section of 65x35 mm supporting frame at center of table bottom with clear PU polish

| Sl.No | NOTES |
|-------|---|
| 1. | DO NOT SCALE THE DRAWING. READ THE DIMENSION ONLY. |
| 2. | ALL DIMENSION ARE IN MM. |
| 3. | ANY DISCREPANCY SHALL BE BROUGHT TO THE NOTICE OF THE ARCHITECT INCHARGE. |

Soft boards on both sides mounted on the Aluminum Partitions :
1. 860mm long X 1260mm height = 1no
2. 1150mm long X 1260mm height = 7 nos

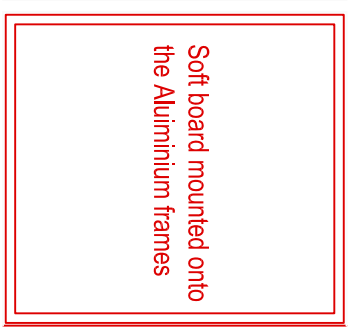

ELEVATION

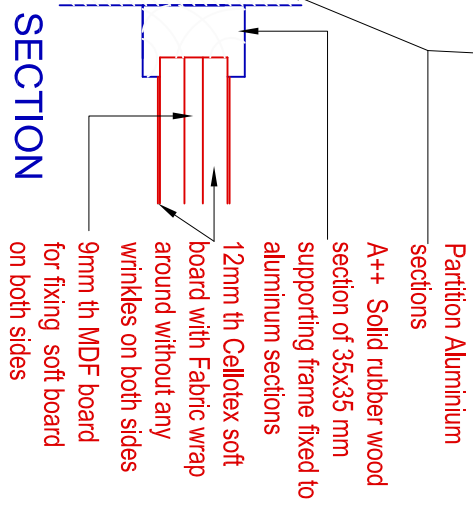

SECTION

| REV. No | DESCRIPTION | DATE |
|--|-------------|------|
| <p>NATIONAL CENTRE FOR BIOLOGICAL SCIENCES, TIFR GKVK CAMPUS, BELLARY ROAD, BLORE-55.</p> <p>EXPANSION OF CENTRAL STORES @ NCBS CAMPUS, GKVK, BANGALORE.</p> <p>PROJECT</p> | | |
| <p>FRONT DESK FOR GROUND FLOOR & SOFT BOARD DETAILS</p> <p>TITLE</p> | | |
| <p>GOOD FOR CONSTRUCTION</p> <p>ARCHITECT Savitha.K.S</p> | | |
| <p>DATE : 25.05.23</p> <p>DRG No.: NCBS/ECS/AR-WP-MW- 48</p> | | |
| <p>SCALE : NTS</p> | | |